



We're proud to introduce to you Seakeeper's newest model, the **Seakeeper 4** for **boats 38-44 feet**. We're sharing the below preliminary spec sheet with you so that you'll have adequate time to incorporate it into your model year 2024 designs where applicable. These specifications are **confidential** and are subject to change within a **reasonable limit**.



TECH SPECS

Max Rated Speed	8,250 RPM
Angular Momentum at Max Rated RPM	4,000 N-M-S
Anti-Rolling Torque at Max Rated RPM	10,427 N-M
Spool-up Time to Max Rated RPM	59 Minutes
Spool-up Time to Stabilization	42 Minutes

Power Consumption

Spool-up Power	1,050 Watts
Spool-up Power Input	12 VDC @ 88 A
Operating Power	550 – 1050
Operating Power Input	12 VDC
Control Power	125 Watts
Control Power Input	12 VDC @ 15 A
Seawater Pump Power Input	12 VDC @ 15 A

Over Current Protection based on installed pump rating

Weight	728 lbs (330 kg)
Envelope Dimensions	26.7 L x 28.06 W x 20.16 H (inches) 0.678 L x 0.712 W x 0.512 H (meters)
Noise Output	<70 dBC at 1 meter
Seawater Supply to Heat Exchanger	6 GPM (22 LPM) maximum 2 GPM (7 LPM) minimum
Ambient Air Temperature	32° – 140° F (0° – 60° C)

PORT VIEW

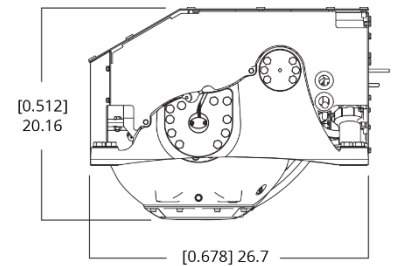

FRONT VIEW

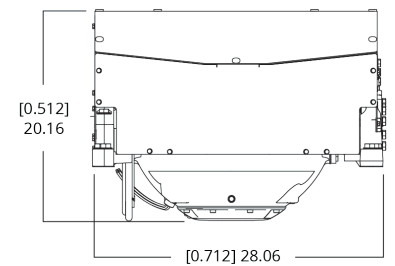

TOP VIEW

